

版次	ECN 编码	描述		设计/日期
1	EL24050071	初版发行		江蒙_2024/05/28
		改前	改后	

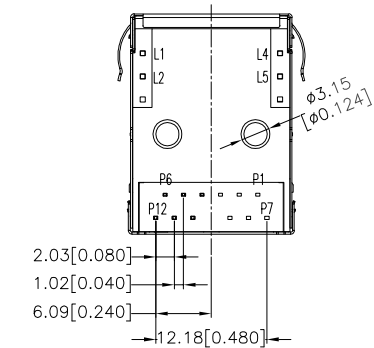

Emitting Color	λ_p (nm)	V_f @ $I_f=20\text{mA}$	I_r @ $V_r=5V$
Green	565	1.7V-2.6V	10uA max.

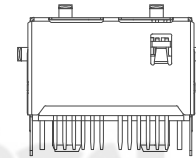
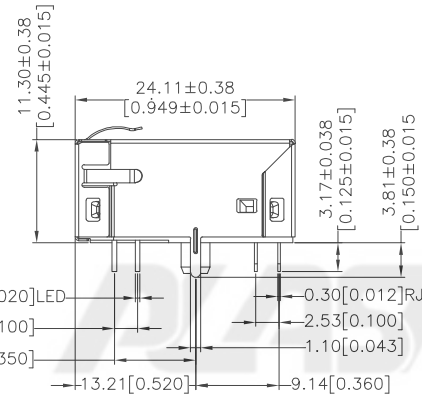
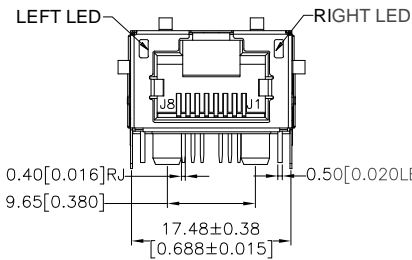
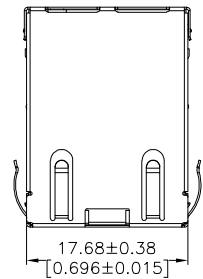
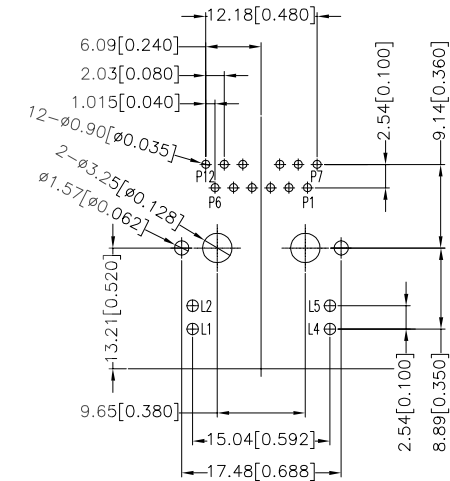

RECOMMENDED PCB LAYOUT



TOLERANCE TABLE	SCALE	2.5:1	DRAWN	江蒙	DATE	2024/05/28	DWG. NO.	TITLE	REV.	
	X. ± 0.30	X.° ± 3°	UNIT	mm	CHECK	李晨涛		DATE	2024/05/28	1
	.X ± 0.25	.X° ± 2°	SIZE	A4	APPROVE	朱宁静	DATE	PARTS NO.(INTENDED USE)	RJ45 IMC, 1G BASE-T, LED CUSTOMER DRAWING	SHEET
	.XX ± 0.20									

SPECIFICATIONS:

1.MATERIAL

-HOUSING : THERMOPLASTIC,LCP,UL 94V-0,BLACK
 -MODULE CASE : HIGH TEMPERATURE THERMOPLASTIC,UL 94V-0, BLACK
 -RJ CONTACTS : PHOSPHOR BRONZE,C5210R-H
 PLATING : SELECT GOLD ON CONTACT AREA (SEE PART NO),
 100u" MIN TIN PLATING ON SOLDER TAILS, 30u" MIN NICKEL OVERALL
 -SOLDER TAIL TERMINAL : BRASS,C2680R-EH,MATTE TIN
 PLATING : 100u" TIN MIN OVER 50u" NICKEL OVERALL
 -SHIELD : STAINLESS,SUS304-1/2H,THICKNESS=0.2MM, NICKEL PLATING

2.RJ45 SPECIFICATIONS

-INSULATION RESISTANCE: 500 MOHMS MIN
 -INSERTION FORCE WITH THE LATCH DEPRESSED :22N MAX
 -REMOVAL FORCE WITH THE LATCH DEPRESSED :44N MAX
 -DURABILITY :750 CYCLES

3. OPERATING AND STORAGE TEMPERATURE

-OPERATING TEMPERATURE:-40°C TO +85°C
 -STORAGE TEMPERATURE:-40°C TO +100°C

4.TEMPERATURE CONDITION OF REFLOW SOLDERING:

Contents	Soldering Condition
A: Increasing speed	3±1 °C/sec
B: Pre-heat starting speed	150°C
C: Pre-heat ending speed	180°C
D: Pre-heat interval	120 sec or over
E: Over 217°C time	60~150 sec
F: Peak Temperature(Tp)	260°C max
Time within 5°C of actual Peak Temp(Tp)	10 sec max
G: Ramp down rate	6°C/sec max

Note:
 Type of lead-free solder should be 96.5Sn-3.0Ag-0.5Cu or 99.3Sn-0.7Cu.

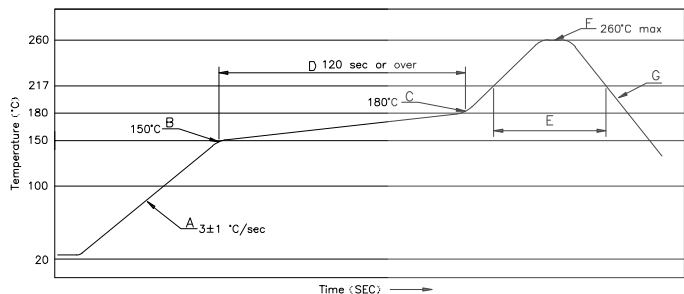

ELECTRICAL CHARACTERISTICS:

- 1.INSERTION LOSS :
 -1~100 MHz -1.0dB MAX.
2. RETURN LOSS(LOAD 100Ω):
 -1~40 MHz -18dB MIN
 -40~100 MHz -12+20LOG(f/80MHz)dB MIN
- 3.COMMON MODE REJECTION
 -1~100 MHz -30dB MIN
- 4.CROSS TALK
 -1~100 MHz -30dB MIN
5. INDUCTANCE @ 100KHz,0.1V, 8mA DC BIAS
 -(P11-P10),(P4-P5),(P3-P2),(P8-P9):350 uH MIN
- 6.DCR
 -(J1-J2),(J3-J6),(J4-J5),(J7-J8) : 1.2 OHM MAX
- 7.HI-POT TEST
 -PCB SIDE TO CABLE SIDE : 1500VAC 60S OR 2250VDC 60S
- 8.TURNS RATION 100KHz
 (P11-P10):(J1-J2) = 1:1 ±%3
 (P4-P5):(J3-J6)=1:1 ±%3
 (P3-P2):(J4-J5)= 1:1 ±%3
 (P8-P9):(J7-J8)= 1:1 ±%3

SCHEMATIC:

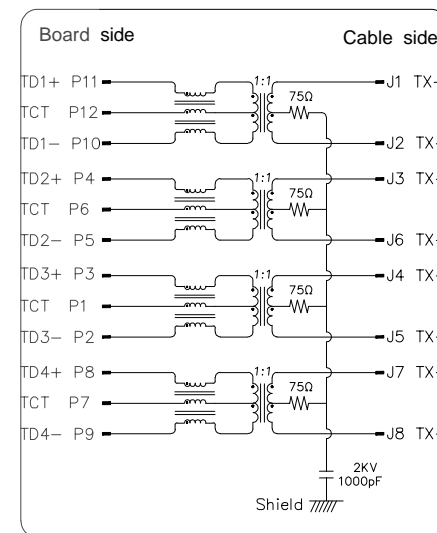

JAADAXAXEDXH
 A:RJ 45
 A:有线圈
 A:LED+屏蔽壳
 H:TRAY
 A:Gold Flash
 D:3u"
 F:6u"
 H:15u"
 L:30u"
 M:50u"
 D:半金锡



TOLERANCE TABLE		SCALE	2.5:1	DRAWN	江蒙	DATE	2024/05/28	DWG. NO.	TITLE	REV.
X. ± 0.30	X.° ± 3°	UNIT	mm	CHECK	李晨涛	DATE	2024/05/28	600-0000-2458	RJ45 IMC, 1G BASE-T, LED	1
.X ± 0.25	.X° ± 2°	SIZE	A4	APPROVE	朱宁静	DATE	2024/05/28	PARTS NO.(INTENDED USE)	CUSTOMER DRAWING	SHEET
.XX ± 0.20								JAADAXAXEDXH		2/4

1-1将成品按其外观形状放入底座对应的凹槽中，产品顶面朝上（如图示一所示）。

1-2每盘TRAY，放满60PCS成品，不可少放或错放。

2-1将底座装满成品，然后盖上上盖（如图示二、三所示）

2-2相叠至9盘共540PCS（如图示五所示），最后在宽度方向用PE膜粘整圈

此产品外观仅供参考

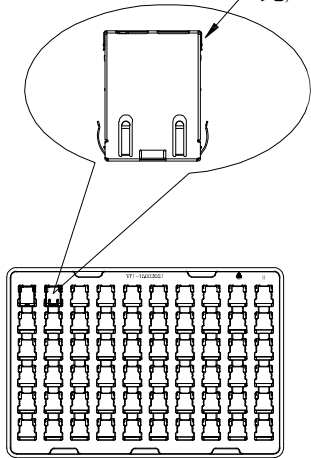

(图一)

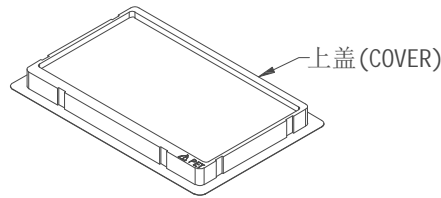

(图二)

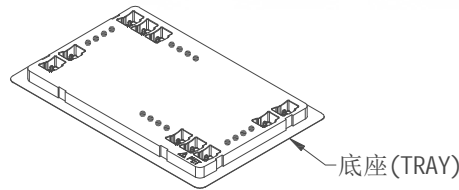

(图三)

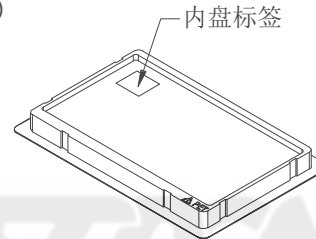

(图四)

9盘共540PCS



标签

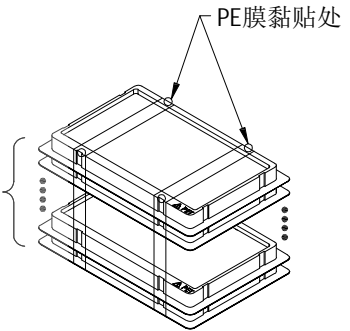

(图五)

产品料号 (Product No.)	包装数量(Packing Quantity)		
	PCS/TRAY	PCS/内箱	PCS/外箱
JAADAXAXEDXH	60	540	2160

DWG. NO. 600-0000-2458	TITLE RJ45 IMC, 1G BASE-T, LED CUSTOMER DRAWING	REV. 1
		PARTS NO.(INTENDED USE) JAADAXAXEDXH

	TOLERANCE TABLE		SCALE 1:1	DRAWN 江蒙	DATE 2024/05/28
	X. ± 0.30	X.° ± 3°	UNIT mm	CHECK 李晨涛	DATE 2024/05/28
	.X ± 0.25	.X° ± 2°	SIZE A4	APPROVE 朱宁静	DATE 2024/05/28
	.XX ± 0.20				

A B C D E

1

2

3

A B C D E

- 3-1先入置一包干燥剂于防水袋底部。
 3-2将完成步骤2，相叠平置于一个防水袋。
 3-3将防水袋整齐折合后，以胶带将其固定好。

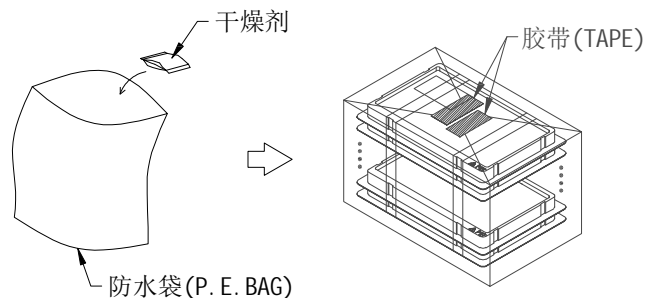

- 5-1把四个内箱装入一外箱中。
 5-2用胶带将外箱封合，并标示料号，数量及包装日期。

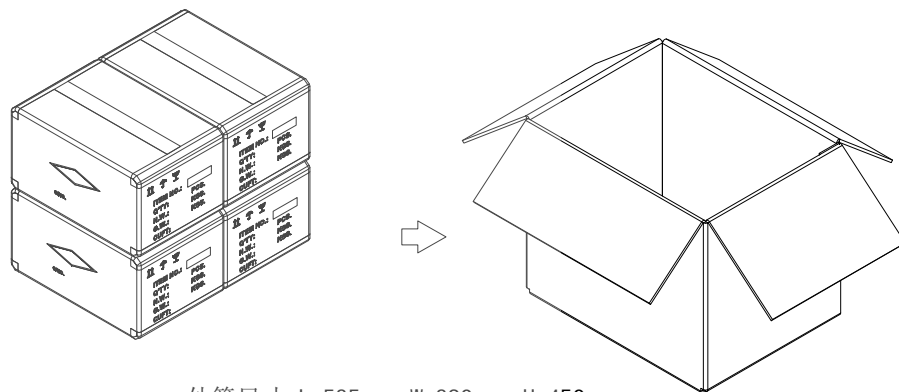

- 4-1先置入1PCS纸浆板于内箱底部，将完成步骤3-3之防水袋置于内箱中
 4-2于四角各置入1PCS角板，再放置1PCS纸浆板于TRA顶部
 4-3以胶带封合，并贴上成品包装标签

外箱尺寸=L: 535mm, W: 390mm, H: 450mm
 内箱尺寸=L: 375mm, W: 253mm, H: 205mm

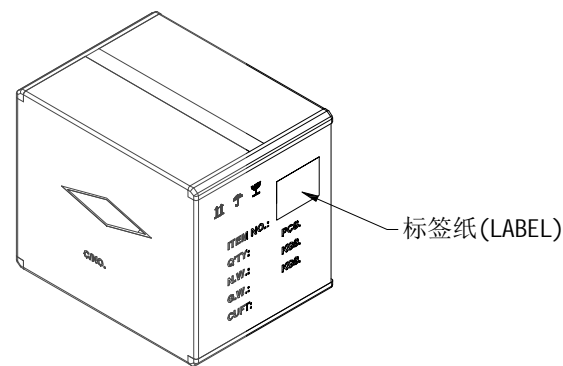
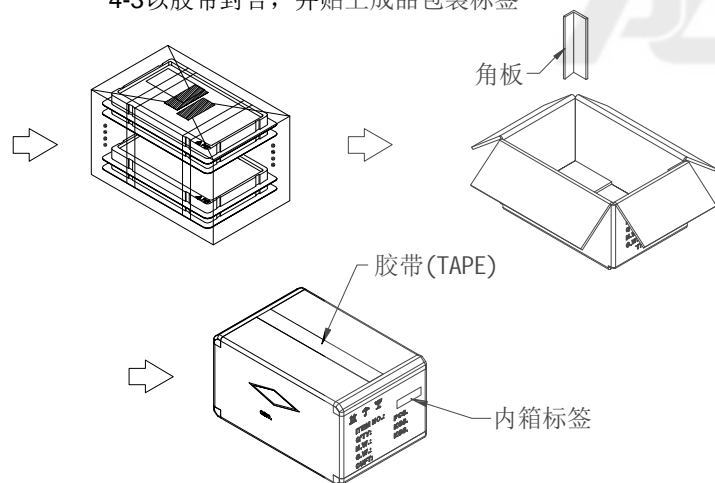

TOLERANCE TABLE	SCALE	1:1	DRAWN	江蒙	DATE	2024/05/28	DWG. NO.	TITLE	REV.	
	X. ± 0.30	X.° ± 3°	CHECK	李晨涛	DATE	2024/05/28				600-0000-2458
	.X ± 0.25	.X° ± 2°	UNIT	mm	APPROVE	朱宁静	DATE	PARTS NO.(INTENDED USE)	CUSTOMER DRAWING	SHEET
	.XX ± 0.20		SIZE	A4			2024/05/28	JAADAXAXEDXH		