

100	49.00	50.00
98	48.00	49.00
96	47.00	48.00
94	46.00	47.00
92	45.00	46.00
90	44.00	45.00
88	43.00	44.00
86	42.00	43.00
84	41.00	42.00
82	40.00	41.00
80	39.00	40.00
78	38.00	39.00
76	37.00	38.00
74	36.00	37.00
72	35.00	36.00
70	34.00	35.00
68	33.00	34.00
66	32.00	33.00
64	31.00	32.00
62	30.00	31.00
60	29.00	30.00
58	28.00	29.00
56	27.00	28.00
54	26.00	27.00
52	25.00	26.00
50	24.00	25.00
48	23.00	24.00
46	22.00	23.00
44	21.00	22.00
42	20.00	21.00
40	19.00	20.00
38	18.00	19.00
36	17.00	18.00
34	16.00	17.00
32	15.00	16.00
30	14.00	15.00
28	13.00	14.00
26	12.00	13.00
24	11.00	12.00
22	10.00	11.00
20	9.00	10.00
18	8.00	9.00
16	7.00	8.00
14	6.00	7.00
12	5.00	6.00
10	4.00	5.00
08	3.00	4.00
06	2.00	3.00
No. of Contacts	A	B

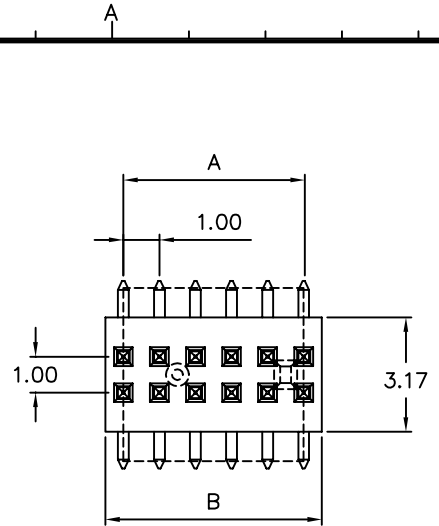

P/N	C
SPUAZ-XXS2-X-016-X-*	1.60
SPUAZ-XXS2-X-017-X-*	1.70
SPUAZ-XXS2-X-019-X-*	1.90
SPUAZ-XXS2-X-020-X-*	2.00
SPUAZ-XXS2-X-030-X-*	3.00
SPUAZ-XXS2-X-032-X-*	3.20
SPUAZ-XXS2-X-034-X-*	3.40
SPUAZ-XXS2-X-038-X-*	3.80
SPUAZ-XXS2-X-040-X-*	4.00
SPUAZ-XXS2-X-045-X-*	4.50

NOTES: (UNLESS OTHERWISE SPECIFIED)

- CURRENT RATING: 1 AMPERE.
- CONTACT RESISTANCE: 20 m ohms MAX. FOR INITIAL.
- DIELECTRIC WITHSTANDING VOLTAGE: 500V AC rms. PER ONE MINUTE.
- INSULATION RESISTANCE: 5000 M ohms MIN..
- HARMFUL MATERIAL SHOULD BE COMPLIANT TO DOC. "EI-0005" STANDARDS.
- PRODUCT NUMBER MATRIX:

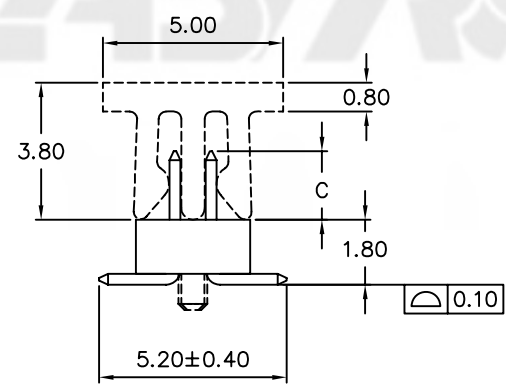
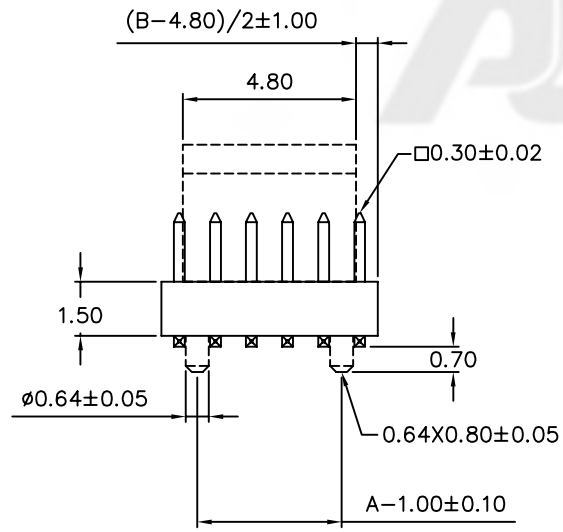

Recommended PCB Layout (PCB TOLERANCE ±0.05)

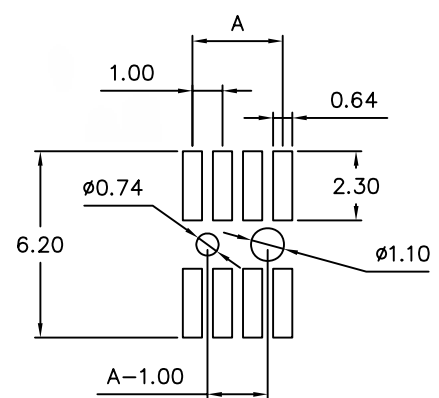

SPUAZ-XXS2-X-C-X-*

Number of Contacts
No. of contacts = Code
06 to 98 Contacts
100 Contacts = A0

Pin Length mm

Contact Plating

Definition	Code
⊙ Tin plated:	A
⊙ Gold plated:	
flash B	15μ" F
10μ" E	30μ" J
⊙ Duplex plating:	
flash K	15μ" P
10μ" N	30μ" U
⊙ Standard:	B
⊙ W:mat tin, low lead<Lead Free>	
⊙ Prefix "V" means lead free plating	

Legend:
 T: PAD+TUBE
 R: PAD+REEL
 0: W/O Locating peg
 1: With Locating peg

	GENERAL TOLERANCE		SCALE 1=1	ORIGINAL DRAWN 邱若婷	DATE 02/01/04'	DWG. NO. 600-0000-0230	TITLE CUSTOMER DRAWING 1.00P, SMD, HEADER	REV. 6
	XX. ± 0.50	XXX. ±	UNIT MM	CHECK Emma shi	DATE 07'/01/05			PARTS NO.(INTENDED USE) SPUAZ-XXS2-X-C-X-*
	X. ± 0.30	.XXX ±	SIZE A4	APPROVE Everard qi	DATE 07'/01/05			
	.X ± 0.25	X.* ± 4'						
.XX ± 0.20	.X.* ± 4'							