

POSD-A0S*	62.23	69.70
POSD-98S*	60.96	68.43
POSD-96S*	59.69	67.16
POSD-94S*	58.42	65.89
POSD-92S*	57.15	64.62
POSD-90S*	55.88	63.35
POSD-88S*	54.61	62.08
POSD-86S*	53.34	60.81
POSD-84S*	52.07	59.54
POSD-82S*	50.80	58.27
POSD-80S*	49.53	57.00
POSD-78S*	48.26	55.73
POSD-76S*	46.99	54.46
POSD-74S*	45.72	53.19
POSD-72S*	44.45	51.92
POSD-70S*	43.18	50.65
POSD-68S*	41.91	49.38
POSD-66S*	40.64	48.11
POSD-64S*	39.37	46.84
POSD-62S*	38.10	45.57
POSD-60S*	36.83	44.30
POSD-58S*	35.56	43.03
POSD-56S*	34.29	41.76
POSD-54S*	33.02	40.49
POSD-52S*	31.75	39.22
POSD-50S*	30.48	37.95
POSD-48S*	29.21	36.68
POSD-46S*	27.94	35.41
POSD-44S*	26.67	34.14
POSD-42S*	25.40	32.87
POSD-40S*	24.13	31.60
POSD-38S*	22.86	30.33
POSD-36S*	21.59	29.06
POSD-34S*	20.32	27.79
POSD-32S*	19.05	26.52
POSD-30S*	17.78	25.25
POSD-28S*	16.51	23.98
POSD-26S*	15.24	22.71
POSD-24S*	13.97	21.44
POSD-22S*	12.70	20.17
POSD-20S*	11.43	18.90
POSD-18S*	10.16	17.63
POSD-16S*	8.89	16.36
POSD-14S*	7.62	15.09
POSD-12S*	6.35	13.82
POSD-10S*	5.08	12.55
POSD-08S*	3.81	11.28
P/N	A	B

REV.	ECN NO.	APPD.
6	EW06090004	Everard qi

NOTES: (UNLESS OTHERWISE SPECIFIED)

1. INSERTION FORCE: 120gf MAX. PER CONTACT.
2. WITHDRAW FORCE: 20gf MIN. PER CONTACT.
3. DURABILITY: 100 CYCLES MIN..
4. CONTACT RETENTION FORCE: 500gf MIN. PER CONTACT.
5. CURRENT RATING: 1 AMPERE.
6. CONTACT RESISTANCE: 20 m ohms MAX. FOR INITIAL.
7. DIELECTRIC WITHSTANDING VOLTAGE: 500V AC rms. PER ONE MINUTE.
8. INSULATION RESISTANCE: 5000 M ohms MIN..
9. HARMFUL MATERIAL SHOULD BE COMPLIANT TO DOC. "EI-0005" STANDARDS.
10. PRODUCT NUMBER MATRIX:

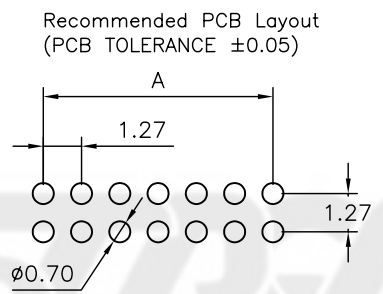
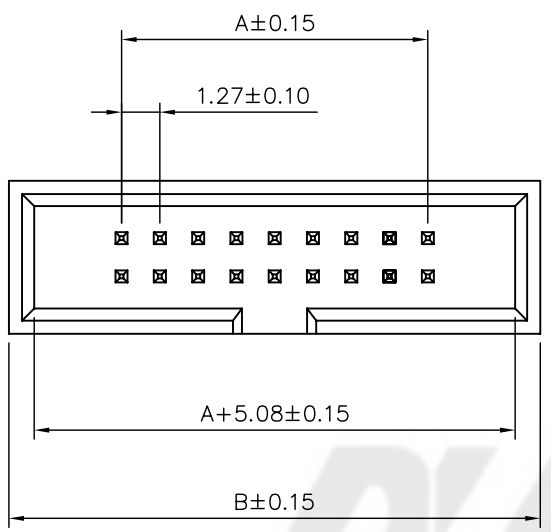

POSD-XXS-X-C
 Number of Contacts Straight
 Pin length mm
 Contact Plating

Definition	Code
◎ Tin plated:	A
◎ Gold plated:	
flash	B 15μ" F
10μ"	E 30μ" J
◎Duplex plating:	
flash	K 15μ" P
10μ"	N 30μ" U
◎Standard: B	
Prefix "V" means lead free plating	

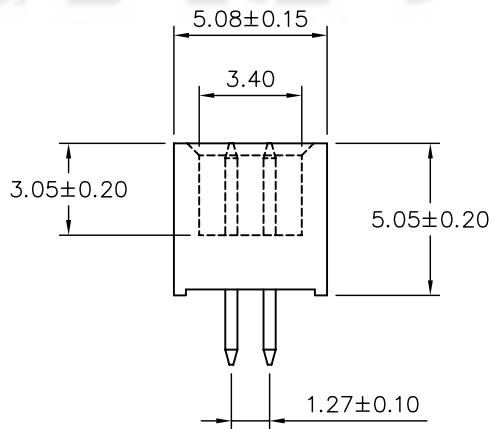
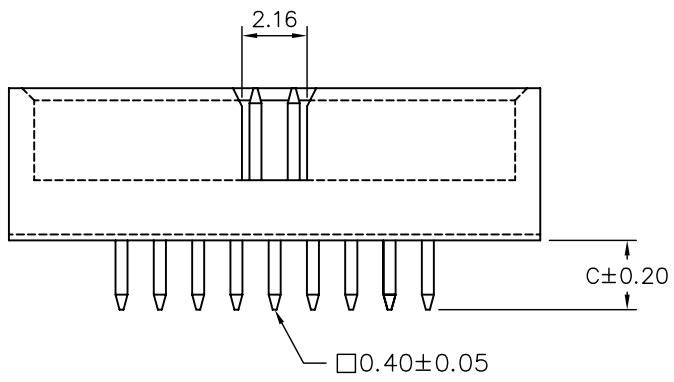

特殊規格
 針長尺寸依
 客戶訂單為標準



GENERAL TOLERANCE		SCALE 1=1	ORIGINAL DRAWN NOKEY	DATE 03/12/15	DWG. NO. 600-0000-0103	TITLE CUSTOMER DRAWING 1.27P, BOX HEADER	REV. 6
XX. ± 0.50	XXX. ±	UNIT MM	CHECK Emma shi	DATE 06/09/01			PARTS NO.(INTENDED USE) POSD-XXS-X-C
X. ± 0.30	.XXX ±			SIZE A4	APPROVE Everard qi	DATE 06/09/01	
.X ± 0.25	X.* ± 4'						
.XX ± 0.20	.X.* ± 4'						