

版次	ECN 编码	描述		设计/日期
1	EH19090126	初版发行		齐如军_2019/11/08
		改前	改后	

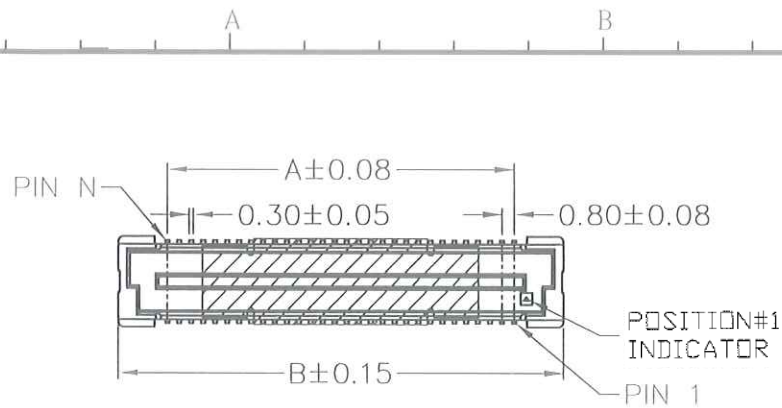

NOTES: (Unless otherwise specified)

- Dimension shall be interpreted per ANSI Y14.5M.
- Materials:
Insulator material: High Temperature Thermoplastic, UL 94V-0; Color: Natural.
Contact material: Copper alloy.
- Current Rating: 0.5A.
- Voltage Rating: 50V AC/DC.
- Working Temperature: -40°C ~ +105°C.
- Harmful material should be compliant to doc. "EI-0005" standards.
- Product number matrix:

BECAAXXB00

Plating Code:

Definition	Code
● Tin plated	A
● Gold plated(Function area)	
flash B 15u"	F
10u" E 30u"	J
● Duplex plated(Function area)	
flash K 15u"	P
10u" N 30u"	U
● Standard: B	

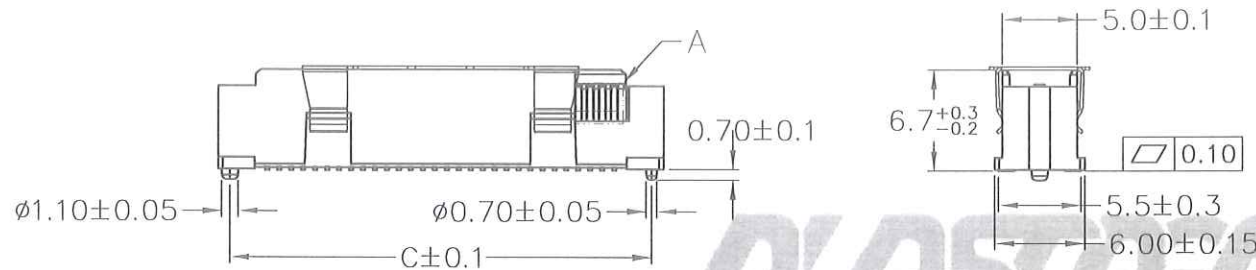

Number of contacts
030~080:30~80PIN
100~140:100~140PIN

B:MPAD+REEL

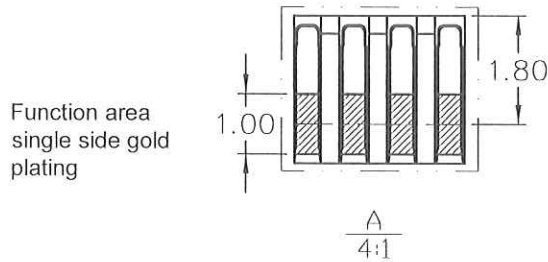

Function area
single side gold
plating

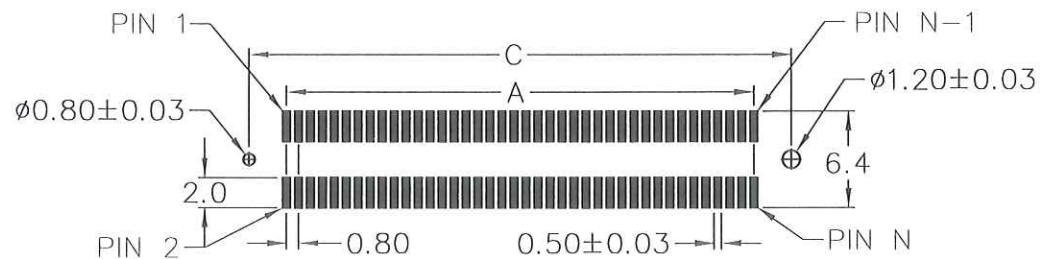

RECOMMENDED PCB LAYOUT
(PCB TOLERANCE ±0.05)

CIRCUITS	DIM.A	DIM.B	DIM.C
30	11.20	17.80	16.20
40	15.20	21.80	20.20
50	19.20	25.80	24.20
60	23.20	29.80	28.20
80	31.20	37.80	36.20
100	39.20	45.80	44.20
120	47.20	53.80	52.20
140	55.20	61.80	60.20



TOLERANCE TABLE	
X. ± 0.30	X.° ± 3°
.X ± 0.25	.X° ± 2°
.XX ± 0.20	

SCALE	2:1
UNIT	mm
SIZE	A4

DRAWN	齐如军	DATE	2019/11/08
CHECK	<i>[Signature]</i>	DATE	2019/11/11
APPROVE	<i>[Signature]</i>	DATE	2019/11/11

DWG. NO.	600-0000-2014
PARTS NO.(INTENDED USE)	BECAAXXB00

TITLE	REV.
CUSTOMER DRAWING	1
	SHEET
	1/3

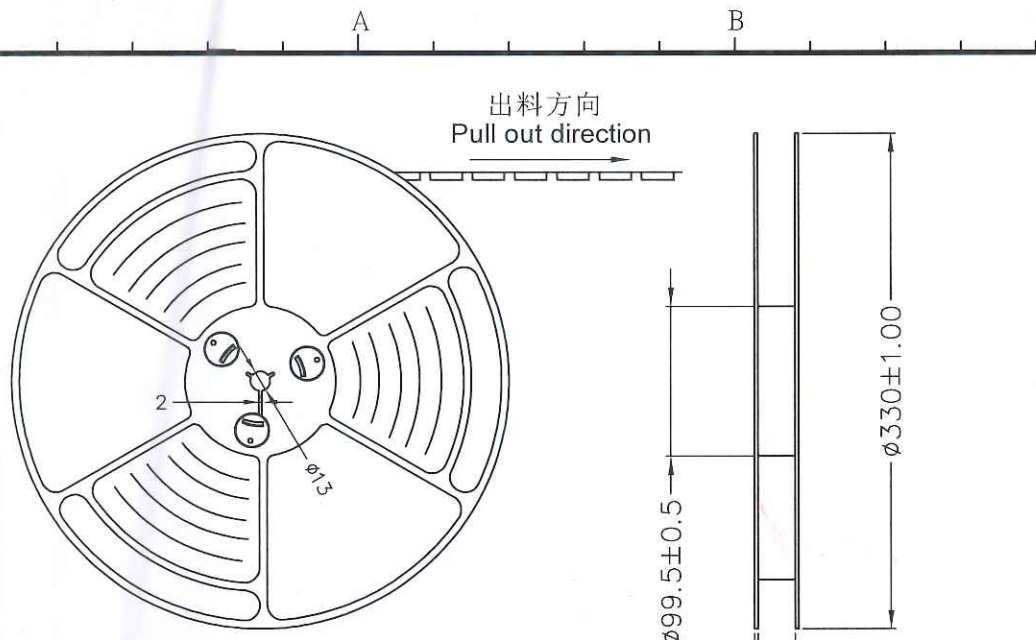

备注 (NOTES):

1. 带子引导长度
Lead tape length

转绕方向
Pull out direction

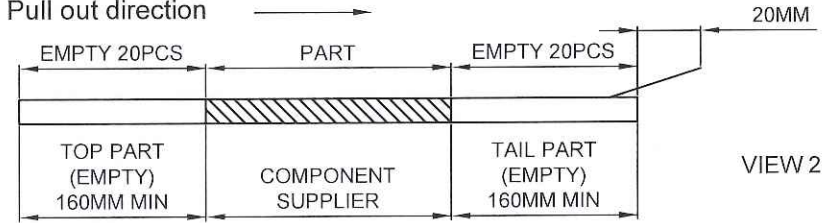

2. 上带剥拉力为: 0.2~1.3N(20gf~130gf)
Peeling off force of top tape :0.2~1.3N(20gf~130gf)

出货运输过程中一定注意: 卷带在运输过程中不能散开
This requirement should be applied at shipment:
The reel tape can not be separated during transportation.

出料方向
Pull out direction

VIEW 1

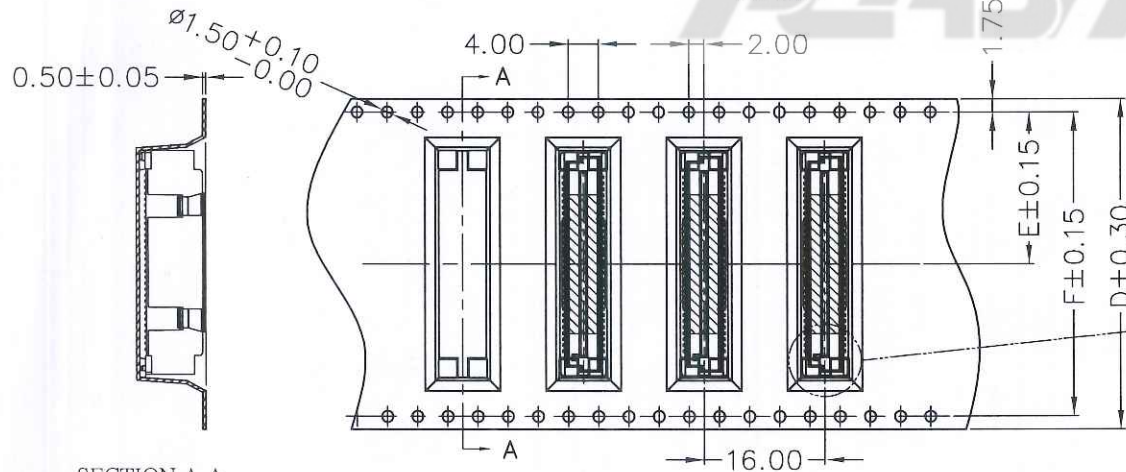

VIEW 3

剥开方向
PEEL OFF
DIRECTION

SECTION A-A

ITEM	P/N	DIM.F	DIM.E	DIM.D
REEL & FILM+REEL & MPAD+REEL	30PIN	40.40	20.25	44.00
	40PIN	40.40	20.25	44.00
	50PIN	40.40	20.25	44.00
	60PIN	40.40	20.25	44.00
	80PIN	52.40	26.25	56.00
	100PIN	68.40	34.25	72.00
	120PIN	68.40	34.25	72.00
	140PIN	84.40	42.25	88.00



TOLERANCE TABLE

X. ± 0.25	X.° ± 3°
.X ± 0.20	.X° ± 2°
.XX ± 0.15	

SCALE 1:1

UNIT mm

SIZE A4

DRAWN

CHECK

APPROVE

齐如军

朱

朱

DATE

DATE

DATE

2019/11/08

2019/11/11

2019/11/11

DWG. NO.

600-0000-2014

PARTS NO.(INTENDED USE)

BECAAXXXBX00

TITLE

CUSTOMER DRAWING

REV.

1

SHEET

2/3

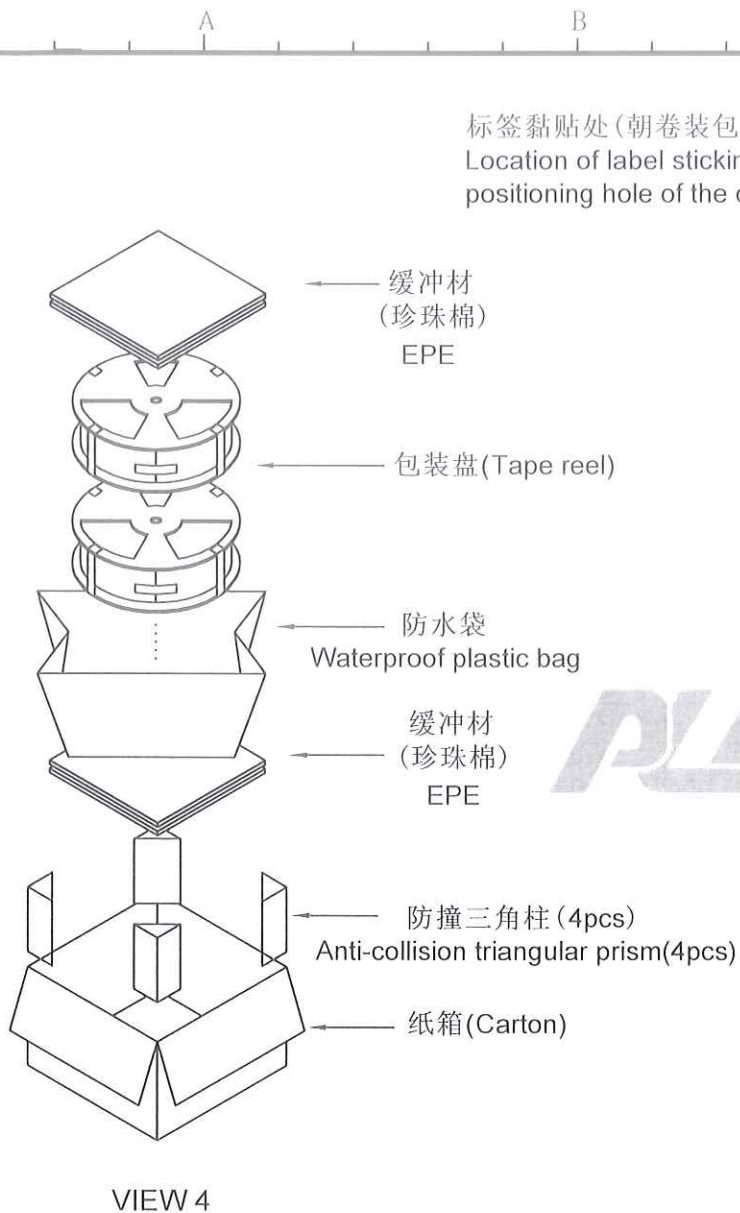

标签黏贴处 (朝卷装包材的小定位孔一侧)
Location of label sticking (label at small positioning hole of the carrier tape side)

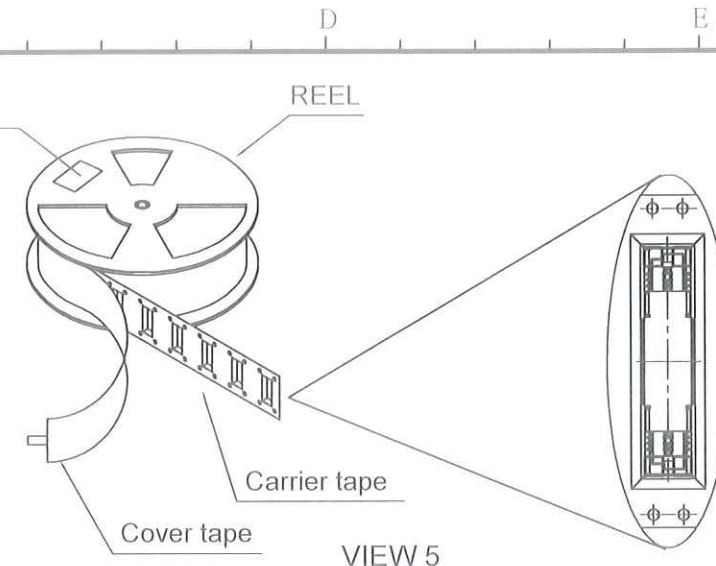

备注 (NOTES):

- 每卷包装数量及每箱装箱数量如下表格。
Packing q'ty of each reel & carton as below table shown.
- 上胶带覆盖下包装带用自粘包装。
Use cover tape to cover and seal up.
- 每个纸箱放2个珍珠棉。
Every carton use 2pcs EPE.
- 将装满产品的卷盘放入纸箱以胶带封口。
Put reels in the carton and use adhesive tape to seal up.

产品料号 (Product No.)	包装容量 (Packing capacity)		
	PCS/REEL	REELS/CARTON	PCS/CARTON
BECAA030BX00	350	4	1400
BECAA040BX00	350	4	1400
BECAA050BX00	350	4	1400
BECAA060BX00	350	4	1400
BECAA080BX00	350	3	1050
BECAA100BX00	350	2	700
BECAA120BX00	350	2	700
BECAA140BX00	350	2	700

PLASTREN

TOLERANCE TABLE

X. ± 0.25	X.° ± 3°
.X ± 0.20	.X° ± 2°
.XX ± 0.15	

SCALE 1:1

UNIT mm

SIZE A4

DRAWN

CHECK

APPROVE

齐如军

陆国峰

朱宇科

DATE

DATE

DATE

2019/11/08

2019/11/11

2019/11/11

DWG. NO.

600-0000-2014

PARTS NO. (INTENDED USE)

BECAAXXBX00

TITLE

CUSTOMER DRAWING

REV.

1

SHEET

3/3