

版次	ECN 编码	描述		设计/日期
1	EH17070180	初版发行		周雨博_2017/07/25
		改前	改后	

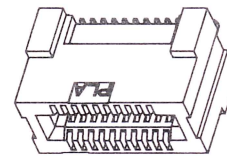
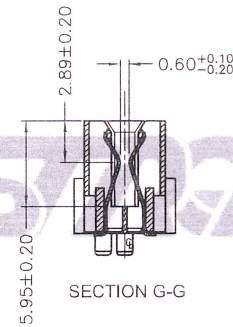
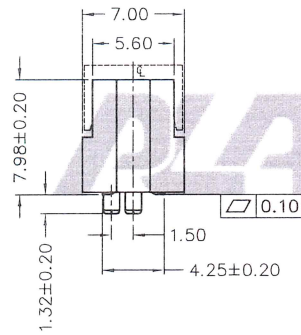
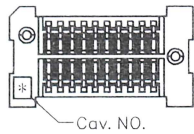
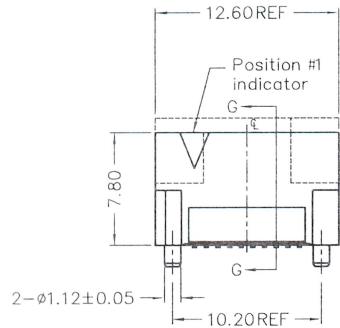
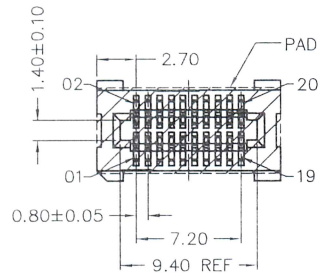

3D VIEW

NOTES: (Unless otherwise specified)

1. Dimension shall be interpreted per ANSI Y14.5M.

2. Materials:

Insulator material: LCP, UL 94V-0; Color: Black.

Contact material: Copper Alloys.

3. Current Rating: 1.5 A .

4. Voltage Rating: 250V AC.

5. Working Temperature: -55 °C ~ +125 °C.

6. Harmful material should be compliant to doc.

"EI-0005" standards.

7. Product number matrix:

PSLOT08-20S1-B-120-H-R

Number of contacts
20:20 PIN

R: PAD+REEL

H: Halogen free

Card thickness: 1.20mm

Plating Code:

Surface area: Plating Au Gold flash.

The bottom layer: Plating Ni 50u" Min.



TOLERANCE TABLE	
X. ± 0.30	X.° ± 3°
.X ± 0.25	.X° ± 2°
.XX ± 0.20	

SCALE	2:1
UNIT	mm
SIZE	A4

DRAWN	周雨博
CHECK	<i>[Signature]</i>
APPROVE	<i>[Signature]</i>

DATE	2017/07/25
DATE	2017/07/25
DATE	2017/07/25

DWG. NO.	600-0000-1765
PARTS NO.(INTENDED USE)	PSLOT08-20S1-B-120-H-R

TITLE	CUSTOMER DRAWING
-------	------------------

REV.	1
SHEET	1/4

A B C D E

标签黏贴处(朝卷装包材的小定位孔一侧)
Location of label sticking (label at small positioning hole of the carrier tape side)

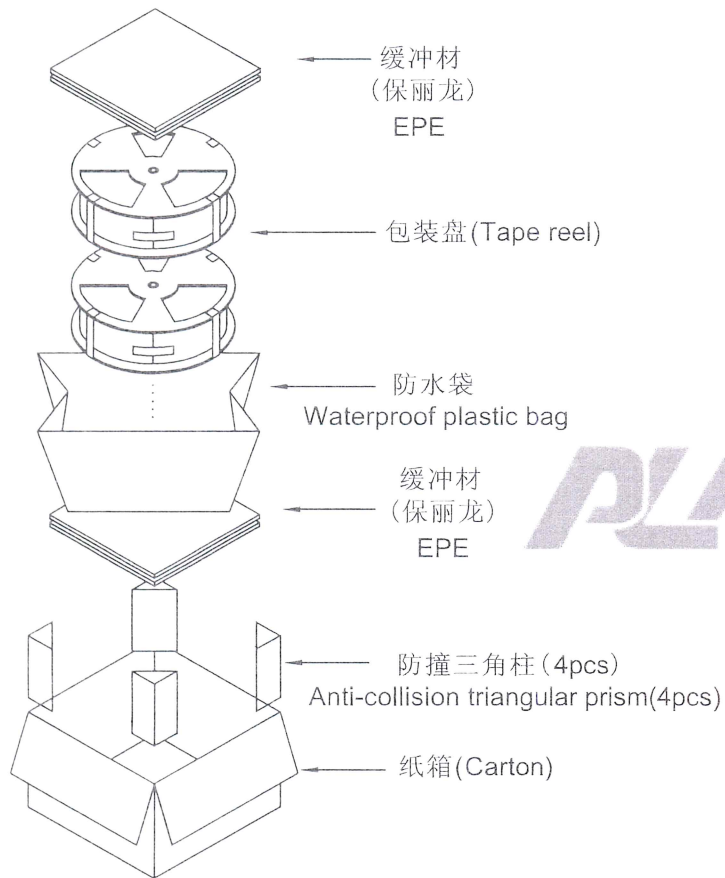

VIEW 4

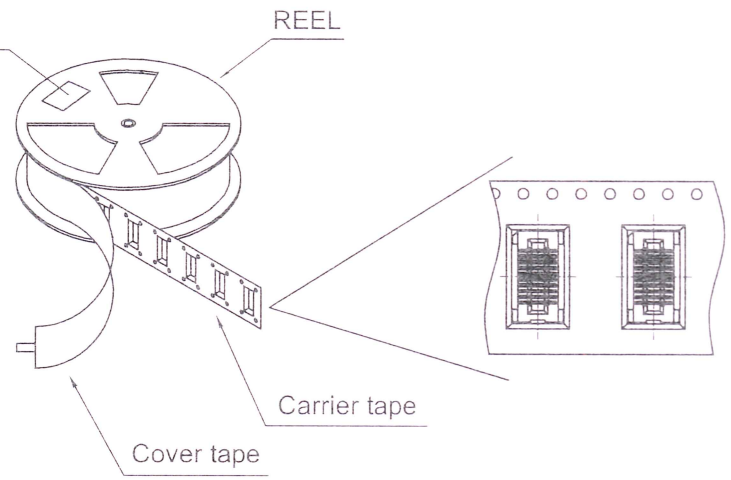

VIEW 5

备注(NOTES):

1. 每卷包装数量及每箱装箱数量如下表格。
Packing q'ty of each reel & carton as below table shown.
2. 上胶带覆盖下包装带用自粘包装。
Use cover tape to cover and seal up.
3. 每个纸箱放2个珍珠棉。
Every carton use 2pcs EPE.
4. 将装满产品的卷盘放入纸箱以胶带封口。
Put reels in the carton and use adhesive tape to seal up.

产品料号 (Product No.)	包装容量(Packing capacity)		
	PCS/REEL	REELS/CARTON	PCS/CARTON
PSLOT08-20S1-B-120-H-R	350	5	1750

	TOLERANCE TABLE		SCALE 1:1	DRAWN 周雨博	DATE 2017/07/25	DWG. NO. 600-0000-1765	TITLE CUSTOMER DRAWING	REV. 1
	X. ± 0.30	X.° ± 3°	UNIT mm	CHECK 高刚	DATE 2017/07/25			PARTS NO.(INTENDED USE) PSLOT08-20S1-B-120-H-R
	.X ± 0.25	.X° ± 2°	SIZE A4	APPROVE 朱梓	DATE 2017/07/25			
	.XX ± 0.20							

A B C D E